

CAMELBACK VILLAGE CONDOMINIUM

EL PASO COUNTY, COLORADO

H. J. KRAETTLI and SONS
ENGINEERS and SURVEYORS

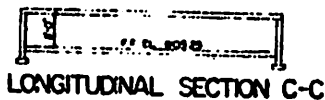
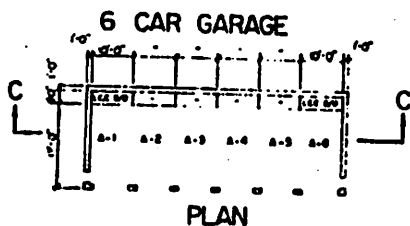
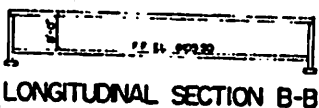
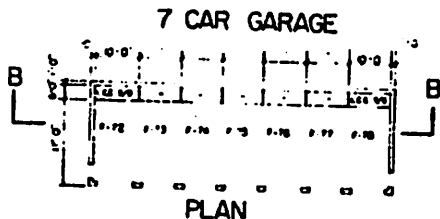
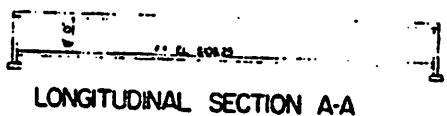
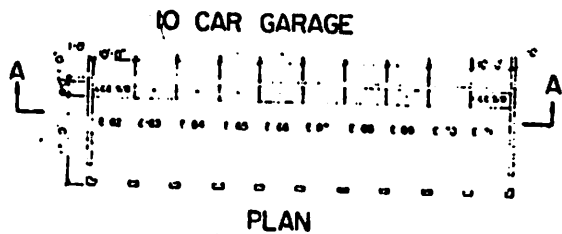

OWNER'S CERTIFICATE

I HEREBY CERTIFY THAT THE FOLLOWING DESCRIBED TRACT OF LAND TO WIT: THAT PORTION OF THE NORTH HALF OF THE SOUTHWEST QUARTER OF SECTION 30, TOWNSHIP 33 NORTH, RANGE 68 WEST OF THE 6th P.M. IS DESCRIBED AS FOLLOWS: COMMENCING AT THE NORTHWEST CORNER OF THE NORTHWEST QUARTER OF THE SOUTHWEST QUARTER OF THE ABOVE DESCRIBED SECTION 30, THENCE S07°10'15" E ALONG THE EASTLINE OF SAID NORTHWEST QUARTER OF THE SOUTHWEST QUARTER OF SAID SECTION 30 A DISTANCE OF 21.00 FEET TO THE "OLD POINT" OF RECORDS OF THE TRACT TO BE DESCRIBED HEREIN, THENCE S88°15'00" E PARALLEL TO THE NORTH LINE OF SAID NORTHWEST QUARTER OF THE SOUTHWEST QUARTER OF SAID SECTION 30 A DISTANCE OF 200.00 FEET, THENCE S88°15'00" E PARALLEL TO THE NORTH LINE OF SAID NORTHWEST QUARTER OF THE SOUTHWEST QUARTER OF SAID SECTION 30 A DISTANCE OF 150.00 FEET, THENCE S88°15'00" E PARALLEL TO THE NORTH LINE OF SAID NORTHWEST QUARTER OF THE SOUTHWEST QUARTER OF SAID SECTION 30 A DISTANCE OF 150.00 FEET TO A POINT "X", THENCE S88°15'00" E PARALLEL TO THE NORTH LINE OF SAID NORTHWEST QUARTER OF THE SOUTHWEST QUARTER OF SAID SECTION 30 A DISTANCE OF 200.00 FEET TO A POINT "Y", THENCE S88°15'00" E PARALLEL TO THE NORTH LINE OF SAID NORTHWEST QUARTER OF THE SOUTHWEST QUARTER OF SAID SECTION 30 A DISTANCE OF 150.00 FEET TO A POINT "Z", THENCE S88°15'00" E PARALLEL TO THE NORTH LINE OF SAID NORTHWEST QUARTER OF THE SOUTHWEST QUARTER OF SAID SECTION 30 A DISTANCE OF 150.00 FEET TO THE POINT OF BEGINNING AND CONTAINING 4.74 ACRES, MORE OR LESS, HAS BEEN SURVEYED AND INSTRUMENTED AS SHOWN ON THE ACCOMPANYING MAP.

CAMELBACK VILLAGE, A GENERAL PARTNERSHIP

STATE OF COLORADO
COUNTY OF EL PASO

THE FOREGOING OWNER'S CERTIFICATE WAS RECORDED BEFORE ME THIS 21st DAY OF August 1971 A.D. BY WHICH IS
WITNESSED PARTNER OF CAMELBACK VILLAGE

BY COMMISSION EXPIRES June 21, 1974 WITNESS MY HAND AND OFFICIAL SEAL.

SURVEYOR'S CERTIFICATE

I HEREBY CERTIFY THAT THE FOLLOWING DESCRIBED TRACT OF LAND TO WIT: THAT PORTION OF THE NORTH HALF OF THE SOUTHWEST QUARTER OF SECTION 30, TOWNSHIP 33 NORTH, RANGE 68 WEST OF THE 6th P.M. IS DESCRIBED AS FOLLOWS: COMMENCING AT THE NORTHWEST CORNER OF THE NORTHWEST QUARTER OF THE SOUTHWEST QUARTER OF THE ABOVE DESCRIBED SECTION 30, THENCE S07°10'15" E ALONG THE EASTLINE OF SAID NORTHWEST QUARTER OF THE SOUTHWEST QUARTER OF SAID SECTION 30 A DISTANCE OF 21.00 FEET TO THE "OLD POINT" OF RECORDS OF THE TRACT TO BE DESCRIBED HEREIN, THENCE S88°15'00" E PARALLEL TO THE NORTH LINE OF SAID NORTHWEST QUARTER OF THE SOUTHWEST QUARTER OF SAID SECTION 30 A DISTANCE OF 200.00 FEET, THENCE S88°15'00" E PARALLEL TO THE NORTH LINE OF SAID NORTHWEST QUARTER OF THE SOUTHWEST QUARTER OF SAID SECTION 30 A DISTANCE OF 150.00 FEET, THENCE S88°15'00" E PARALLEL TO THE NORTH LINE OF SAID NORTHWEST QUARTER OF THE SOUTHWEST QUARTER OF SAID SECTION 30 A DISTANCE OF 150.00 FEET TO A POINT "X", THENCE S88°15'00" E PARALLEL TO THE NORTH LINE OF SAID NORTHWEST QUARTER OF THE SOUTHWEST QUARTER OF SAID SECTION 30 A DISTANCE OF 200.00 FEET TO A POINT "Y", THENCE S88°15'00" E PARALLEL TO THE NORTH LINE OF SAID NORTHWEST QUARTER OF THE SOUTHWEST QUARTER OF SAID SECTION 30 A DISTANCE OF 150.00 FEET TO A POINT "Z", THENCE S88°15'00" E PARALLEL TO THE NORTH LINE OF SAID NORTHWEST QUARTER OF THE SOUTHWEST QUARTER OF SAID SECTION 30 A DISTANCE OF 150.00 FEET TO THE POINT OF BEGINNING AND CONTAINING 4.74 ACRES, MORE OR LESS, HAS BEEN SURVEYED AND INSTRUMENTED AS SHOWN ON THE ACCOMPANYING MAP.

ENGINEER'S CERTIFICATE

I HEREBY CERTIFY THAT THE ACCOMPANYING MAP SUBSTANTIALLY DEPICTS THE LOCATION AND THE HORIZONTAL AND VERTICAL MEASUREMENTS OF ALL THE LAYOUTS AND IMPROVEMENTS IN THE ABOVE DESCRIBED TRACT, THE CONDOMINIUM UNIT DESIGNATIONS, AND THE BUILDING SYMBOLS, AND THAT THE ACCOMPANYING MAP HAS BEEN PREPARED SUBSEQUENT TO SUBSTANTIAL COMPLETION OF SAID CONDOMINIUM IMPROVEMENTS.

STATE OF COLORADO
COUNTY OF EL PASO

ACCEPTED FOR FILING IN THE OFFICE OF THE CLERK AND RECORDER OF EL PASO COUNTY, COLORADO, IN 1971 AT EL PASO, TEXAS, THIS 21st DAY OF August 1971, A.D. IN WITNESS WHEREOF I HAVE RECEIVED HIS Signature

FORNEY SEALS, COUNTY CLERK AND RECORDER

BY Signature
CLERK

NOTES

1. DESIGNATIONS A, B, C, D REFER TO THE STYLE OF THE UNITS WITHIN THE CONDOMINIUM AND THE FLOOR PLANS WHICH ARE SHOWN ON SHEETS 20-A
2. THE DESCRIPTION OF EACH UNIT IS ESTABLISHED BY THE ADDRESS NO. AND BUILDING NO. C.D. 2000-C, BLDG. NO. 0
3. ALL ELEVATIONS ARE USGS CONTROL, WITH DATUM OF MEAN SEA LEVEL.
4. ELEVATIONS FOR BLDG. NO. 1, ELEVATIONS FOR BLDG. NO. 2, ELEVATIONS FOR BLDG. NO. 3
- 1ST FLOOR - NORTH 00'00" SOUTH 00'00" 1ST FLOOR - NORTH 00'00" SOUTH 00'00" 1ST FLOOR - NORTH 00'00" SOUTH 00'00"
- 2ND FLOOR - 00'00" 00'00" 2ND FLOOR - 00'00" 00'00" 2ND FLOOR - 00'00" 00'00"
5. ELEVATIONS FOR BLDG. NO. 4, ELEVATIONS FOR BLDG. NO. 5, ELEVATIONS FOR BLDG. NO. 6
- 1ST FLOOR - NORTH 00'00" SOUTH 00'00" 1ST FLOOR - NORTH 00'00" SOUTH 00'00" 1ST FLOOR - NORTH 00'00" SOUTH 00'00"
- 2ND FLOOR - 00'00" 00'00" 2ND FLOOR - 00'00" 00'00" 2ND FLOOR - NORTH 00'00" SOUTH 00'00"
6. ELEVATIONS FOR BLDG. NO. 7, ELEVATIONS FOR BLDG. NO. 8
- 1ST FLOOR - NORTH 00'00" SOUTH 00'00" 1ST FLOOR - NORTH 00'00" SOUTH 00'00"
- 2ND FLOOR - 00'00" 00'00" 2ND FLOOR - 00'00" 00'00"
7. L.C.E. AC. 6 LIMITED COMMON ELEMENT CONCRETE AIR CONDITONER AND
8. L.C.E. BLD. 10 LIMITED COMMON ELEMENT STORAGE BIN

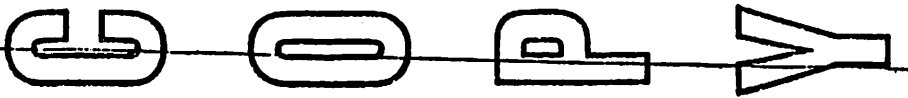

CAMELBACK VILLAGE CONDOMINIUM

EL PASO COUNTY, COLORADO

H. J. KNAEITTL and SONS
ENGINEERS and SURVEYORS

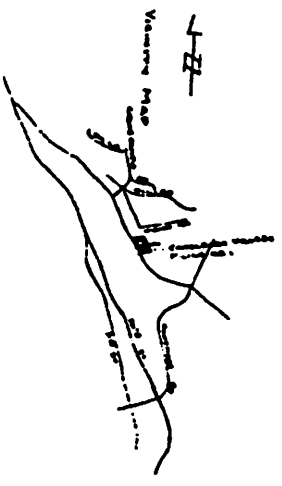
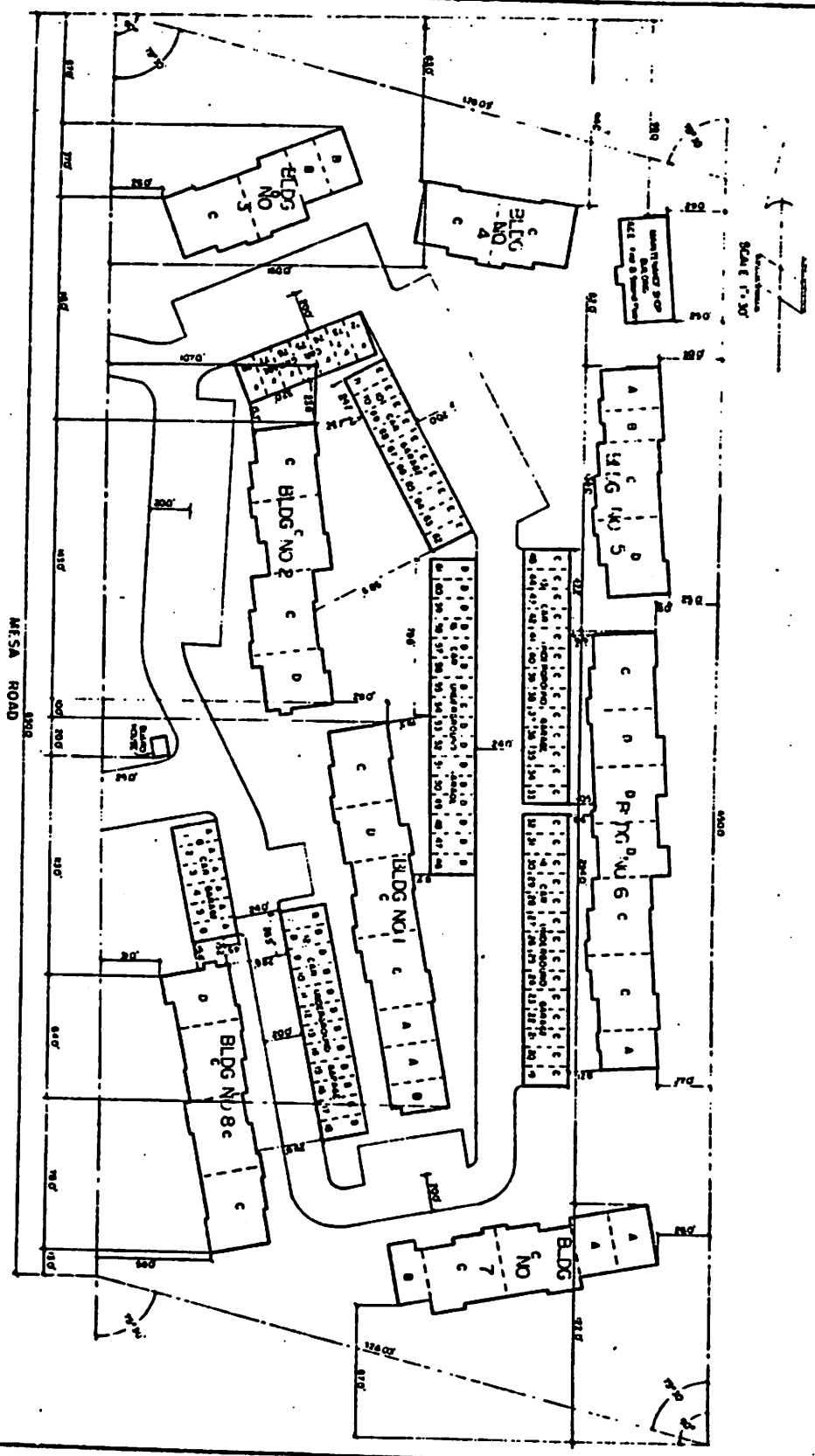

COOPY

CAMELBACK VILLAGE CONDOMINIUM

BLDG. NO. 1

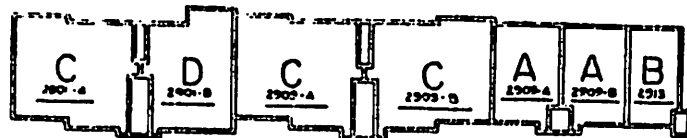

Basement & First Floor

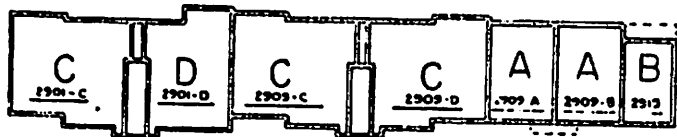

2nd Floor

BLDG. NO. 6

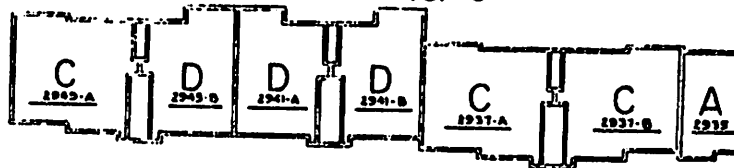

Basement & First Floor

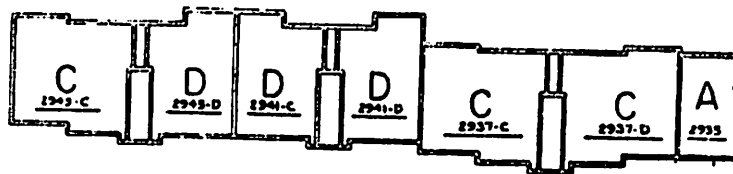

2nd Floor

BLDG. NO. 3

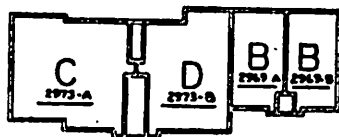

Basement & First Floor

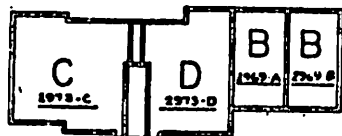

2nd Floor

BLDG. NO. 4

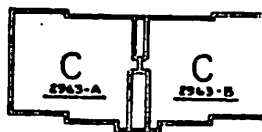

Basement & First Floor

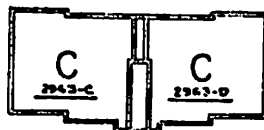

2nd Floor

BLDG. NO. 5

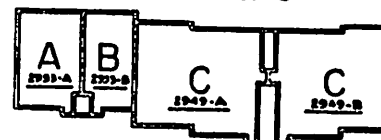

Basement & First Floor

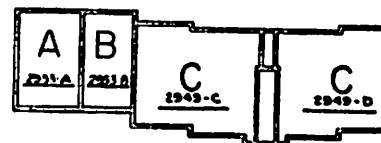

2nd Floor



Scale 1/20

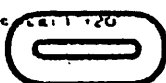

CAMELBACK VILLAGE CONDOMINIUM

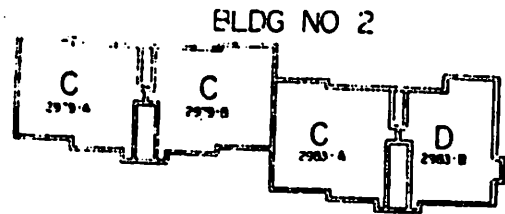

FIRST FLOOR

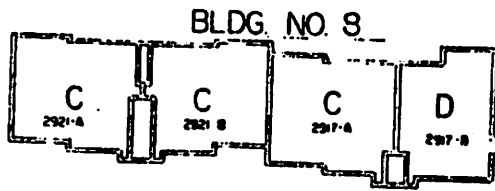

FIRST FLOOR

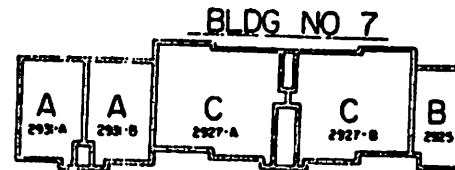

FIRST FLOOR

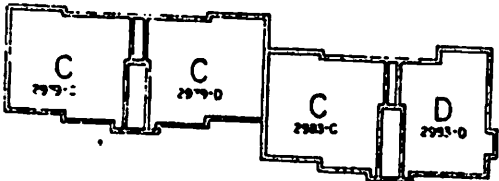

SECOND FLOOR

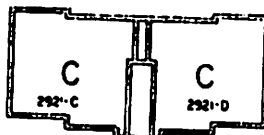

SECOND FLOOR

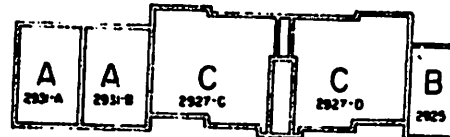

SECOND FLOOR

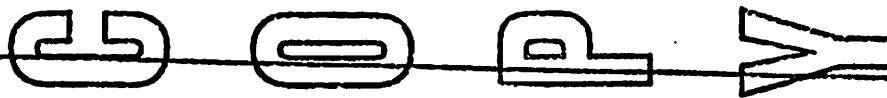
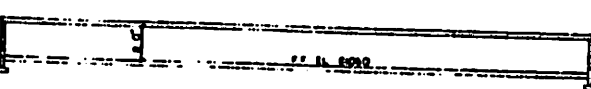
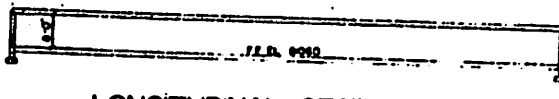
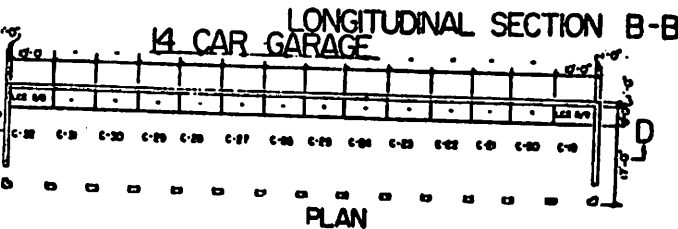
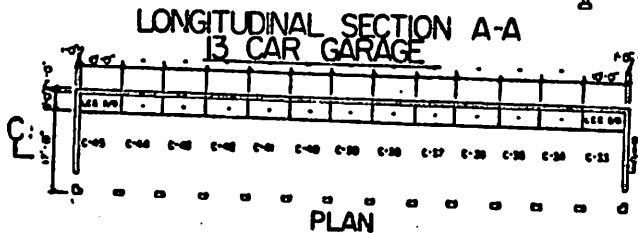
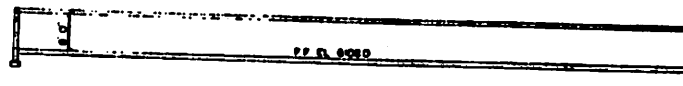
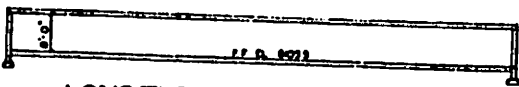
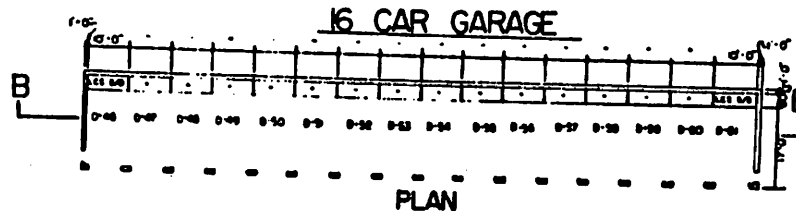
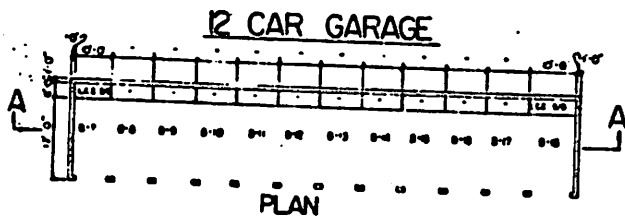

CAMELBACK VILLAGE CONDOMINIUM

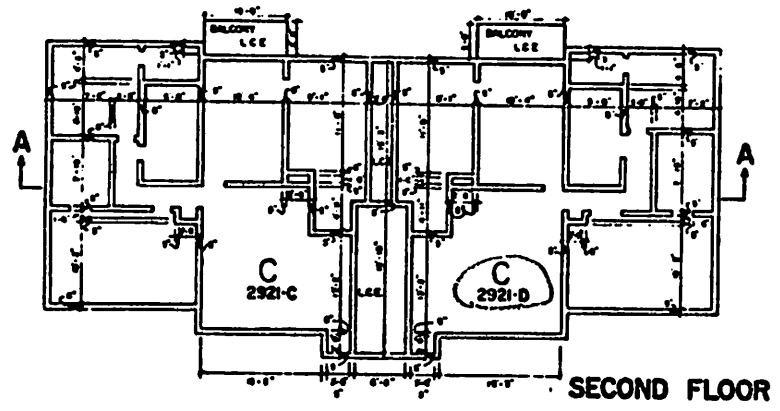
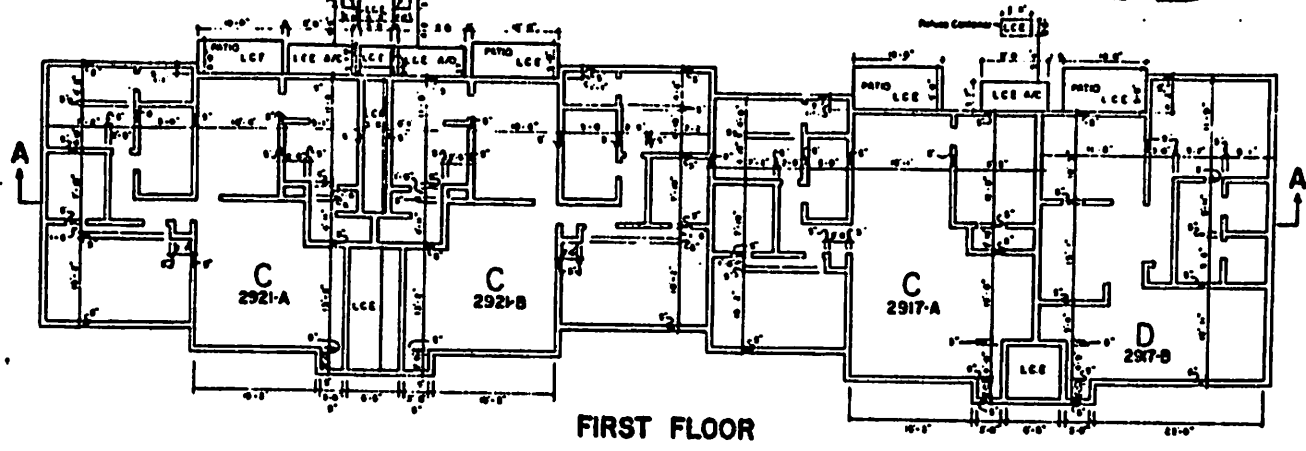

BLDG. NO. 8

SCALE 1/8"=1'

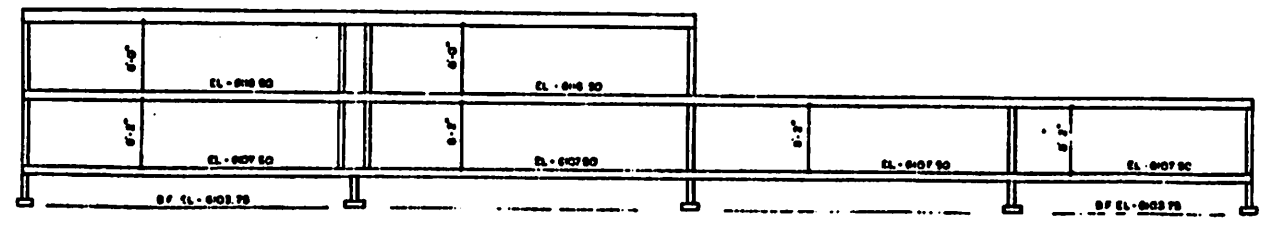

LONGITUDINAL SECTION A-A